

CABINETGIANT®

Wall Cabinet

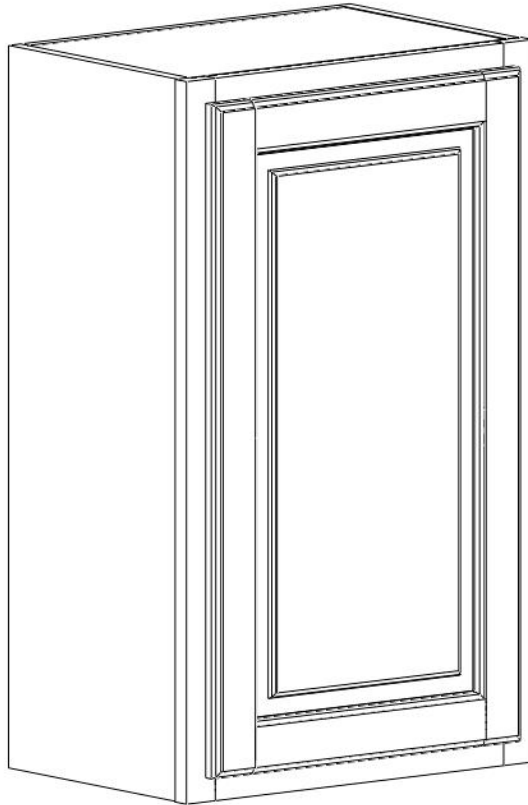

Assembly Guide

More assembly info available at:
www.cabinetgiant.com/assembly

1

CABINETGIANT
The Savings Makes  Smiles.
www.cabinetgiant.com

Hey there! Assembling our cabinets is really simple, but in case you're a little nervous, this guide should help. Simply follow this quick guide and you'll be a cabinet assembly master in no time. It's painless, promise!

Unlike many other ready-to-assemble (RTA) cabinets on the market, ours require NO hot glue guns, NO staple guns, NO bar clamps, or anything more sophisticated than a Phillips screwdriver and rubber mallet. NO KIDDING!

To speed up the assembly process, it can help to use an electric screwdriver. It also helps if two people work together on very large cabinets – one holding the cabinet parts in place, while the other tightens the screws.

Even if you hire your own installer, you've saved thousands by eliminating the middleman fees charged by cabinet companies that maintain expensive showrooms.

Cabinet Giant's maple, oak, bamboo and birch cabinets are shipped to customers with the hinges already secured to the doorframe faces, making your life easier. Our factory also pre-drills and attaches all the cam-locks before shipping the cabinets to you. Doing this saves you a lot of time and makes assembling both easier and more intuitive.

All hardware, mounting brackets, shelves, drawer pulls and screws are provided. A few extra screws are included as well. Dovetailed drawers that are not pre-assembled can be tapped together with a rubber mallet.

As with anything new you do, there's a learning curve. Handy and experienced do-it-yourselfers, as well as total novices are usually able to assemble each of our other RTA cabinets within 10-15 minutes. Ready-to-Assemble cabinets that may take a little longer to assemble include drawer base cabinets, bathroom vanities and lazy susans.

Let's get to it!

Step 1 | Unpack & Organize

 1-2 mins

Place your RTA cabinet panels on a smooth, scratch resistant surface in a large, open area. Some people like to work on a carpeted area; others prefer to elevate the cabinet by placing it on a table top. If you are not using a carpeted area, use the foam sheets and box the cabinet came in to help protect the cabinet from being scratched during assembly.

Next, we'll identify which cool fastening system your cabinets use and learn how it works.

2

Questions?

More assembly info available at:
www.cabinetgiant.com/assembly
or drop us an email at:
support@cabinetgiant.com

CABINETGIANT
The Savings Makes  Smiles.
www.cabinetgiant.com

Step 2 | Identify Fastening System

⌚ 1 mins

We use several different fastening systems. They are all great, but they attach differently, so let's figure out what you have and how it works. For the rest of the instructions, we'll use the terms 'Steel Spring Clips', or 'Plastic Cams' to reference the fastening systems. They're all over the cabinet, so spotting them is easy.

Steel Spring Clips OR Plastic Cams

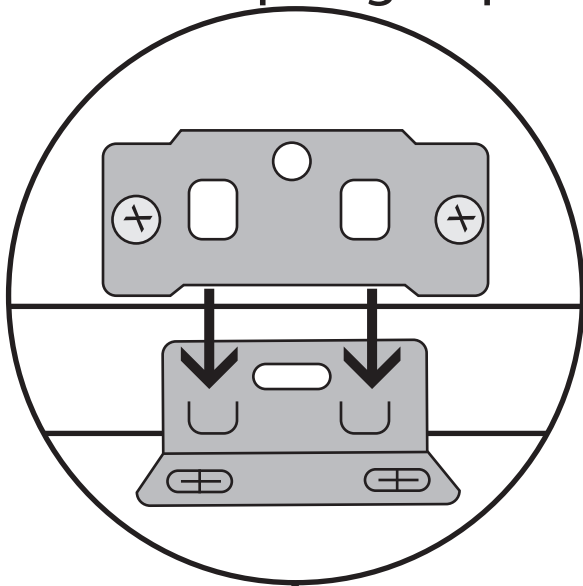

Pop clip into place
& lock in place using most
plentiful round head screws
in hardware bag

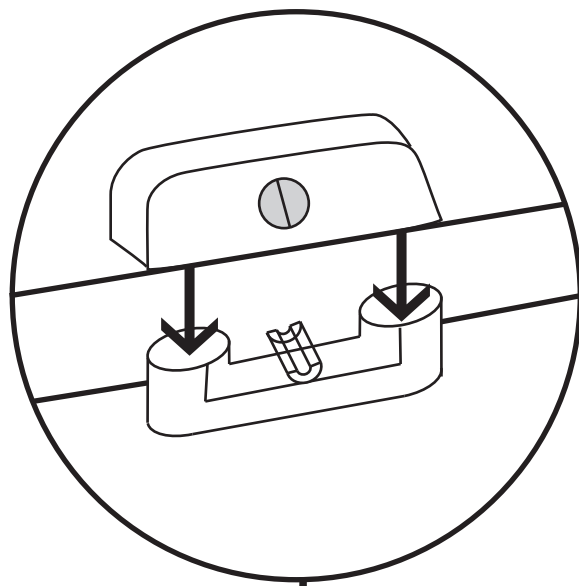
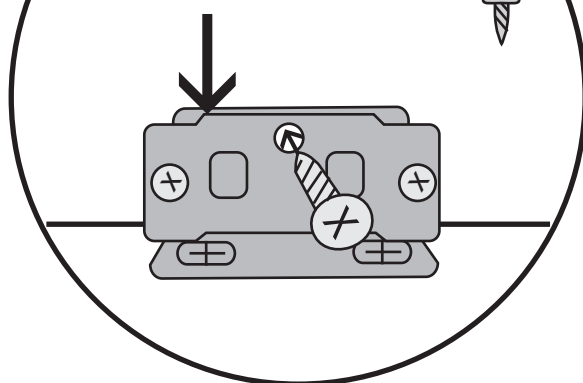

Seat female cam into
place on top of male cam,
then turn metal claw mechanism
180 degrees clockwise with flat head
screwdriver to lock into place

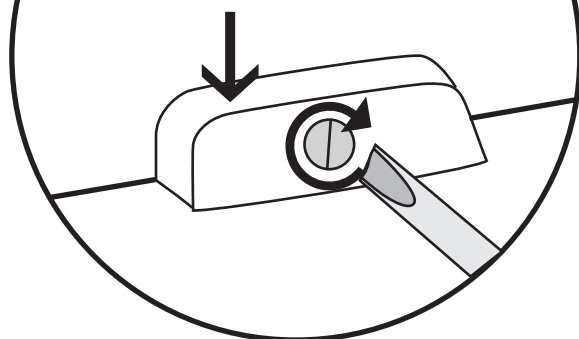

3

Questions?

More assembly info available at:
www.cabinetgiant.com/assembly
or drop us an email at:
support@cabinetgiant.com

CABINETGIANT
The Savings Makes Smiles.
www.cabinetgiant.com

Step 3 | Attach Sides To Front

 2-3 mins

Set front of cabinet, face down on your padded work surface.

Line up fasteners on the side of the cabinet with fasteners on the front of the cabinet, locking the fasteners in place. Repeat with other side of the cabinet.

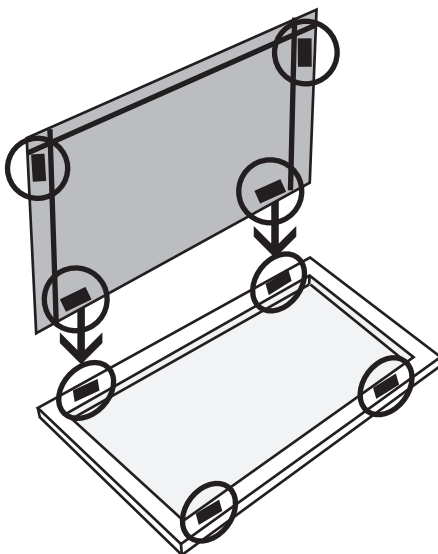
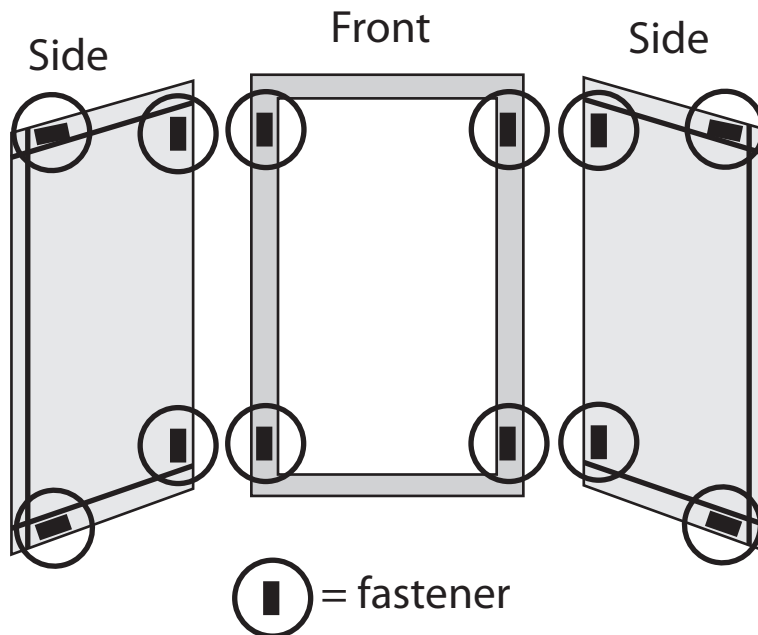

● = fastener

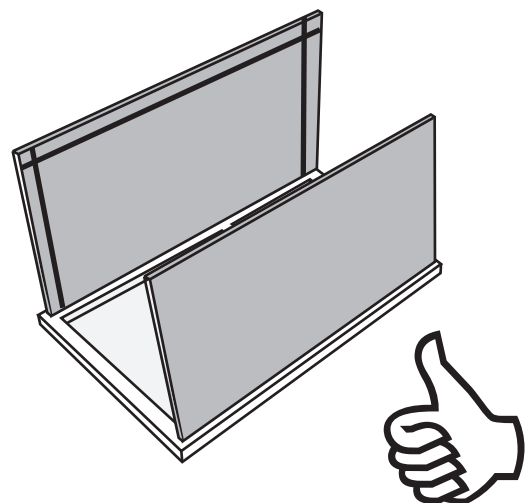

4

Questions?

More assembly info available at:
www.cabinetgiant.com/assembly
or drop us an email at:
support@cabinetgiant.com

CABINETGIANT
The Savings Makes  Smiles.
www.cabinetgiant.com

Step 4 | Top & Bottom

⌚ 1 min

Slide the top and bottom of the floor of the cabinet into place using the dado joints (see diagram) as to guide you. Using care, lightly bend the side of the cabinet away from the bottom, until you can fully seat the top & bottom of the cabinet fully into place. Then, use the fasteners to lock the pieces into place.

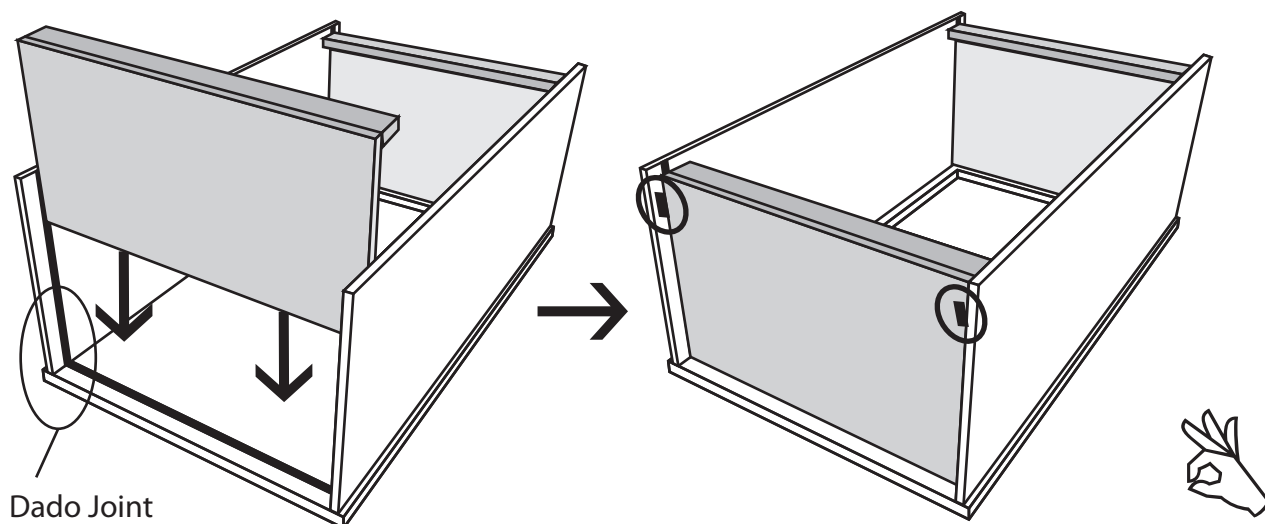

Step 5 | Back It Up

⌚ 1 mins

Slide the back of the cabinet into place as shown. Use 4 longer screws included with hardware to lock the back of the cabinet into place.

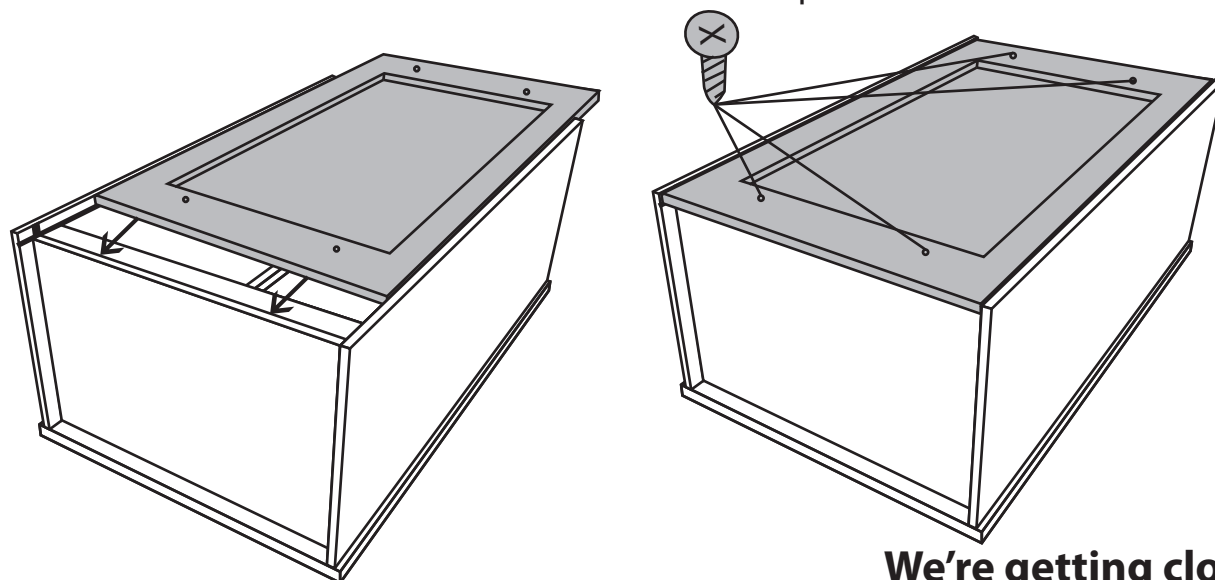

We're getting close...

5

Questions?
More assembly info available at:
www.cabinetgiant.com/assembly
or drop us an email at:
support@cabinetgiant.com

CABINETGIANT
The Savings Makes Smiles.
www.cabinetgiant.com

Step 7 | Shelving

⌚ 1-2 min

From the hardware bag, put the clear acrylic shelf clips into place. Pop the shelf into position.

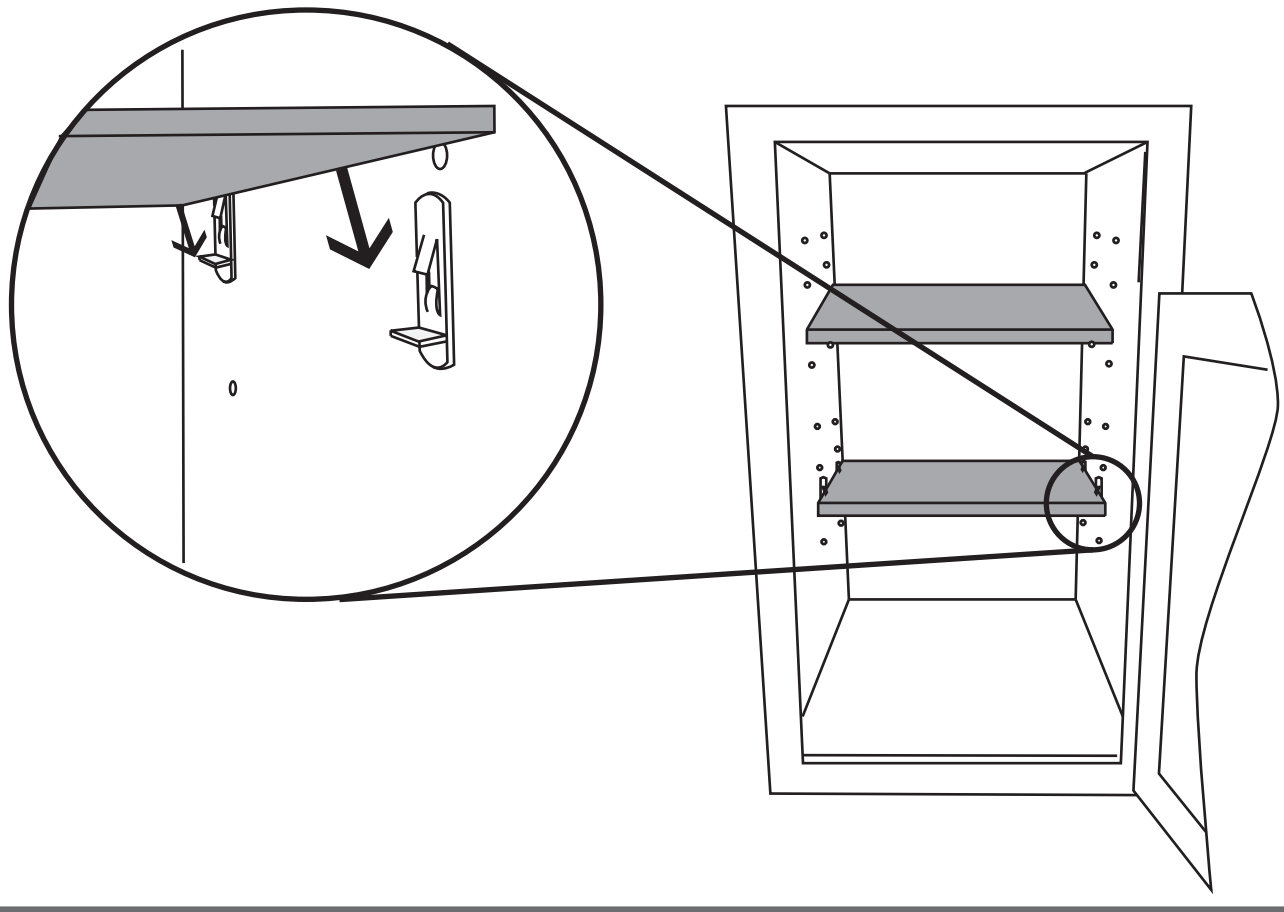

Congratulations!!! You did a great job!

Normally, we'd say that you deserved a break, but honestly that was really easy and only took a few minutes. Get back to work. 😊

6

Questions?
More assembly info available at:
www.cabinetgiant.com/assembly
or drop us an email at:
support@cabinetgiant.com

CABINETGIANT
The Savings Makes Smiles.
www.cabinetgiant.com