



# CABINETGIANT

HIGH QUALITY CABINETRY

KITCHEN & BATH  
CATALOG

Visit us at [www.CabinetGiant.com](http://www.CabinetGiant.com)

# cG wall Cabinets

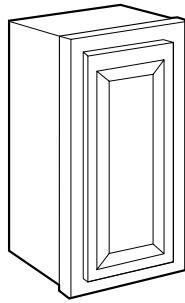

SINGLE  
DOOR  
WALL

Sizes	Standard	Elite	Reserve
W0930	✖	✖	✖
W1230	✖	✖	✖
W1530	✖	✖	✖
W1830	✖	✖	✖
W2130	✖	✖	✖
W0936		✖	✖
W1236		✖	✖
W1536		✖	✖
W1836		✖	✖
W2136		✖	✖
W0942	✖	✖	✖
W1242	✖	✖	✖
W1542	✖	✖	✖
W1842	✖	✖	✖
W2142	✖	✖	✖

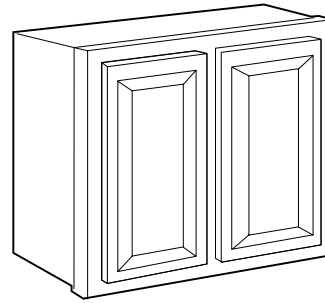

DOUBLE  
DOOR  
WALL

Sizes	Standard	Elite	Reserve
W2430	✖	✖	✖
W2730	✖	✖	✖
W3030	✖	✖	✖
W3330	✖	✖	✖
W3630	✖	✖	✖
W2436		✖	✖
W2736		✖	✖
W3036		✖	✖
W3336		✖	✖
W3636		✖	✖
W2442	✖	✖	✖
W2742	✖	✖	✖
W3042	✖	✖	✖
W3342	✖	✖	✖
W3642	✖	✖	✖

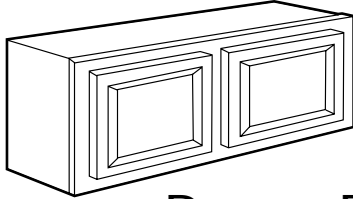

DOUBLE DOOR  
WALL BRIDGE

Sizes	Standard	Elite	Reserve
W2415	✖	✖	✖
W3012	✖	✖	✖
W3015	✖	✖	✖
W3018	✖	✖	✖
W3024	✖	✖	✖
W3315	✖	✖	✖
W3612		✖	✖
W3615	✖	✖	✖
W3618		✖	✖
W3624	✖	✖	✖
W361224		✖	✖
W301524		✖	
W331524	✖	✖	✖
W361524	✖	✖	✖
W361824			✖
W332424	✖	✖	✖
W362424	✖	✖	✖

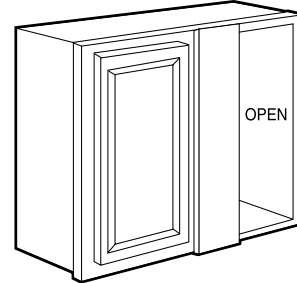

WALL  
BLIND  
CORNER

Sizes	Standard	Elite	Reserve
WBC2730	✖	✖	✖
WBC2736		✖	✖
WBC2742	✖	✖	✖

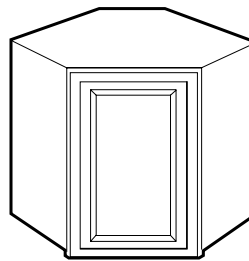

WALL  
DIAGONAL  
CORNER

Sizes	Standard	Elite	Reserve
WDC2430	✖	✖	✖
WDC2436		✖	✖
WDC2736		✖	✖
WDC2442	✖	✖	✖
WDC2742	✖	✖	✖



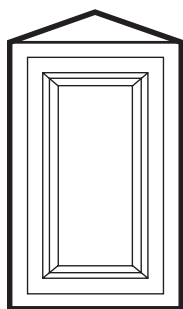

## ANGLE WALL

TAKES UP 12" OF WALL SPACE

Sizes	Standard	Elite	Reserve
AW30		✕	✕
AW36		✕	✕
AW42		✕	✕

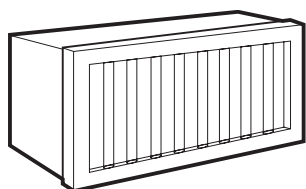

## PLATE RACK

Size	Standard	Elite	Reserve
ITEM	PR3015	PlateR	W3015PL
30"W x 15" H	✕	✕	✕

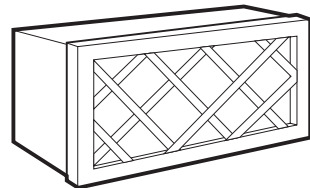

## WINE RACK

CAN BE HORIZONTAL  
OR VERTICAL

Size	Standard	Elite	Reserve
ITEM	WR3015	WR30	W3015WR
30"W x 15" H	✕	✕	✕

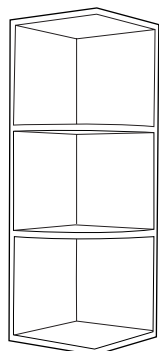

## WALL END SHELF

TAKES UP 12" OF WALL SPACE

Sizes	Standard	Elite	Reserve
WES1230			✕
WES1236			✕
WES1242			✕

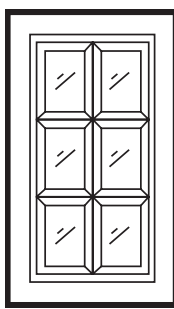

## MULLION DOORS

GLASS INCLUDED  
IN ELITE LINE ONLY

Sizes	Standard	Elite	Reserve
W1230GD		✕	✕
W1530GD	✕	✕	✕
W1830GD	✕	✕	✕
W2430GD		✕	✕
W3030GD	✕	✕	✕
W3630GD	✕	✕	✕
W1236GD		✕	✕
W1536GD		✕	✕
W1836GD		✕	✕
W2436GD		✕	✕
W3036GD		✕	✕
W3636GD		✕	✕
W1242GD		✕	✕
W1542GD		✕	✕
W1842GD		✕	✕
W2442GD		✕	✕
W3042GD		✕	✕
W3642GD		✕	✕
W3015GD			✕
W3615GD			✕
WDC2430GD	✕	✕	✕
WDC2436GD		✕	✕
WDC2442GD	✕	✕	✕
WDC2736GD		✕	✕
WDC2742GD	✕	✕	✕

WDC [WALL DIAGONAL CORNER]  
GLASS DOORS CAN BE USED FOR  
AW [ANGLE WALL] CABINETS



RUSTIC TUSCANY OAK

# CG Base Cabinets

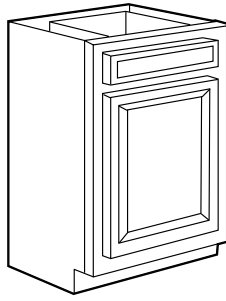

**SINGLE  
DOOR  
BASE**

B09 IN STANDARD LINE COMES  
WITH DOOR ONLY [NO DRAWER]

Size	Standard	Elite	Reserve
B09	✖	✖	✖
B1	✖	✖	✖
B15	✖	✖	✖
B18	✖	✖	✖
B21	✖	✖	✖

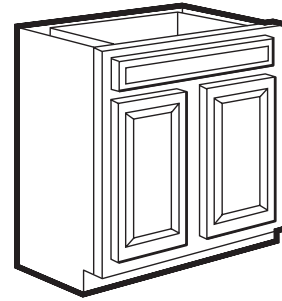

**DOUBLE  
DOOR  
BASE**

Size	Standard	Elite	Reserve
B24	✖	✖	✖
B27	✖	✖	✖
B30	✖	✖	✖
B33	✖	✖	✖
B36	✖	✖	✖
B39		✖	✖
B42	✖	✖	✖

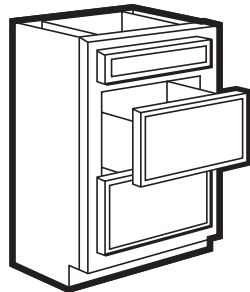

**BASE  
DRAWER  
UNIT**

THREE DRAWERS IN UNIT

Size	Standard	Elite	Reserve
DB15	✖	✖	✖
DB18	✖	✖	✖
DB21	✖	✖	✖
DB24		✖	✖
DB27		✖	✖
DB30	✖	✖	✖

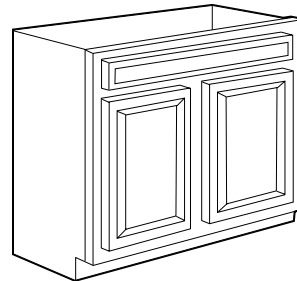

**SINK  
BASE  
UNIT**

Sizes	Standard	Elite	Reserve
SB30	✖	✖	✖
SB33	✖	✖	✖
SB36	✖	✖	✖
SB39		✖	
SB42	✖	✖	✖
SB60	✖	✖	✖

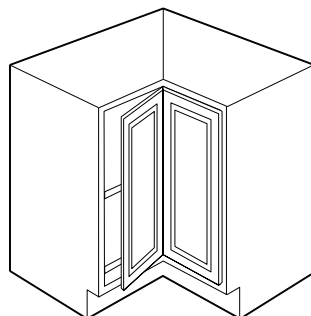

**LAZY SUSAN**

FROM BACK CORNER  
36" x 36"

Size	Standard	Elite	Reserve
ITEM	DCB3612	LS3612	LS3612
36" x 36"	✖	✖	✖

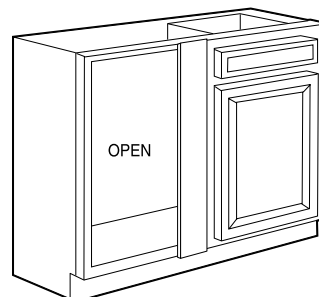

**BASE  
BLIND  
CORNER**

TAKES UP 42-45" TOTAL WALL SPACE  
1-3" FILLER REQUIRED ON ADJACENT SIDE

	Standard	Elite	Reserve
Needs 42" Wall Space	BBC36	BBC3639	BBC3639
	✖	✖	✖

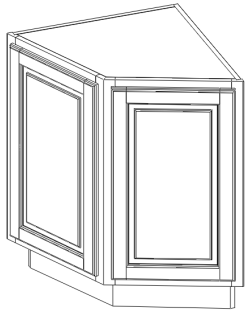

ANGLE  
BASE

<i>Size</i>	<i>Standard</i>	<i>Elite</i>	<i>Reserve</i>
AB24		✖	✖

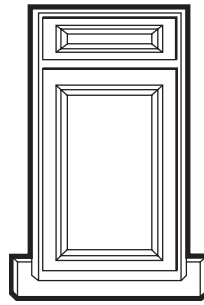

DIAGONAL  
CORNER  
SINK FRONT

REQUIRES 36" x 36"  
OF WALL SPACE BEHIND

<i>Sizes</i>	<i>Standard</i>	<i>Elite</i>	<i>Reserve</i>
ITEM	CSF36	BDC36	BDCF36K
36" x 36"	✖	✖	✖

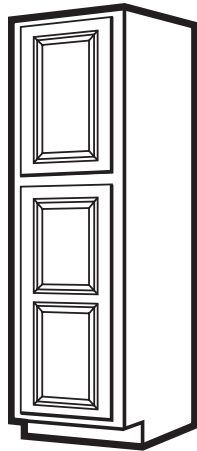

SINGLE DOOR  
WALL PANTRY

ONE DOOR ABOVE,  
ONE DOOR BELOW

<i>Sizes</i>	<i>Standard</i>	<i>Elite</i>	<i>Reserve</i>
WP1884	✖	✖	✖
WP1890		✖	✖
WP1896	✖	✖	✖

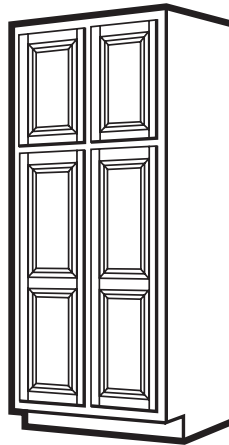

DOUBLE  
DOOR WALL  
PANTRY

TWO DOORS ABOVE,  
TWO DOORS BELOW

<i>Sizes</i>	<i>Standard</i>	<i>Elite</i>	<i>Reserve</i>
WP2484	✖	✖	✖
WP2496		✖	✖
WP2496	✖	✖	✖

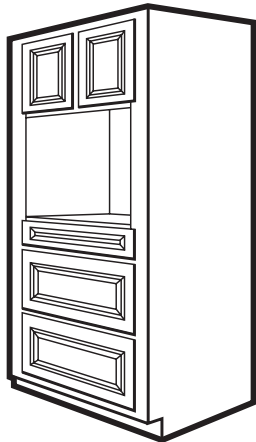

SINGLE  
OVEN  
CABINET

<i>Sizes</i>	<i>Standard</i>	<i>Elite</i>	<i>Reserve</i>
OC3384	✖	✖	✖
OC3390		✖	✖
OC3396	✖	✖	✖

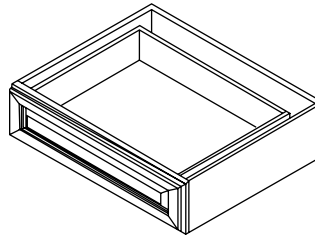

SINGLE  
DESK  
DRAWER

<i>Size</i>	<i>Standard</i>	<i>Elite</i>	<i>Reserve</i>
SDU3021		✖	✖

# CG Moldings AND Accessories

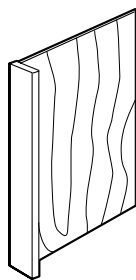

## DISHWASHER BASE END PANEL

INCLUDES 3" FACE RETURN

	<i>Standard</i>	<i>Elite</i>	<i>Reserve</i>
ITEM	BEP3RT	DWR	DWR
	✕	✕	✕

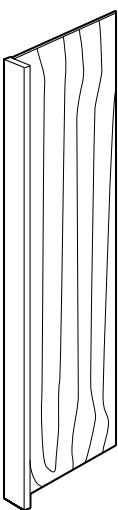

## REFRIGERATOR END PANEL

INCLUDES 3" FACE RETURN

<i>Sizes</i>	<i>Standard</i>	<i>Elite</i>	<i>Reserve</i>
84" H	RP84L	REP84	REP2484
	✕	✕	✕
90" H		REP90	REP2490
		✕	✕
96" H	RP96L	REP96	REP2496
	✕	✕	✕

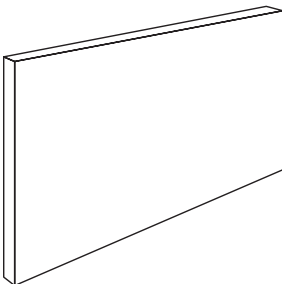

## FINISHED ISLAND BACK PANEL

48"W x 36"H x 1/4" D

	<i>Standard</i>	<i>Elite</i>	<i>Reserve</i>
ISLANDPNL	✕	✕	✕

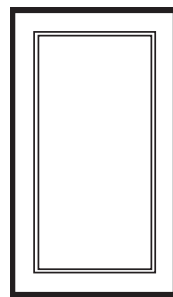

## DECORATIVE DOOR PANEL

FITS ON SIDES OF CABINETS  
CAN BE ALSO USED ON ISLAND  
CONFIGURATIONS

<i>Sizes</i>	<i>Standard</i>	<i>Elite</i>	<i>Reserve</i>
BASE		B24D00R	EPB24D
		✕	✕
30"H WALL		W30D00REPW1230D	
		✕	✕
36"H WALL		W36D00REPW1236D	
		✕	✕
42"H WALL		W42D00REPW1242D	
		✕	✕



## VALANCE

48" W CAN BE CUT DOWN TO SIZE

<i>Type</i>	<i>Standard</i>	<i>Elite</i>	<i>Reserve</i>
STRAIGHT - VA48	✕		✕
SCALLOP - VAS48	✕	✕	



## DECORATIVE BASE LEG

<i>Type</i>	<i>Standard</i>	<i>Elite</i>	<i>Reserve</i>
TP3		✕	✕

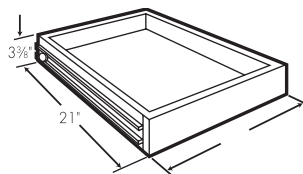

## ROLL OUT TRAY

FITS BOTH PANTRY AND BASE CABINETS

<i>Sizes</i>	<i>Standard</i>	<i>Elite</i>	<i>Reserve</i>
FOR 18" UNITS	RD18	18RT	18RT
	✕	✕	✕
FOR 24" UNITS		24RT	24RT
		✕	✕



## SOLID WALL FILLER STRIP

CAN BE CUT DOWN TO ANY SIZE

Type	Standard	Elite	Reserve
3"W x 30"H	FS30	WF3-30	WF3
	✗	✗	✗
6"W x 30"H		WF6-30	WF6
		✗	✗
3"W x 36"H		WF3-36	WF336
	✗	✗	✗
6"W x 36"H		WF6-36	WF636
		✗	✗
3"W x 42"H	FS42	WF3-42	WF342
	✗	✗	✗
6"W x 42"H		WF6-42	WF642
		✗	✗
3"W x 96"H			WF396
			✗



## UNDER WALL CABINET MOLDING

ALSO CALLED LIGHT RAIL MOLDING

Type	Standard	Elite	Reserve
LRM8	✗	✗	✗

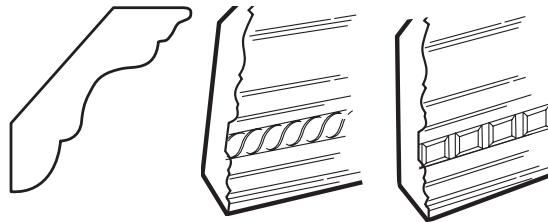

## CROWN MOLDING

Type	Standard	Elite	Reserve
	CM8	CM96A	CM96A
STANDARD	✗	✗	✗
		CM96C	CM96C
ROPE		✗	✗
		CM96D	CM96D
DENTIL		✗	✗

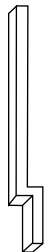

## SOLID BASE FILLER WITH TOEKICK

CAN BE CUT DOWN TO ANY SIZE

Sizes	Standard	Elite	Reserve
BF3	✗	✗	✗
BF6		✗	✗

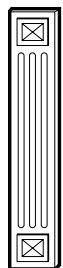

## SOLID DECORATIVE WALL FILLER STRIP

Sizes	Standard	Elite	Reserve
A30WF		✗	✗
A36WF		✗	✗
A42WF		✗	✗

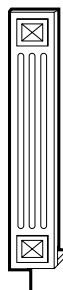

## SOLID DECORATIVE BASE FILLER WITH TOEKICK

Sizes	Standard	Elite	Reserve
A3BF		✗	✗
A6BF		✗	✗

## VARIOUS TRIMS

COME IN 96" L

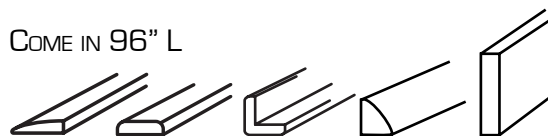

Type	Standard	Elite	Reserve
SCRIBE	SCRIBE	SC1-3	SC1-3
	✗	✗	✗
BATTEN		SC2	SC2
		✗	✗
OUTSIDE CORNER	O.S.C.	SC5	SC5
	✗	✗	✗
QUARTER ROUND			SC9
			✗
TOEKICK	TK8	TK8	TK8
	✗	✗	✗



# CG Bathroom Cabinets

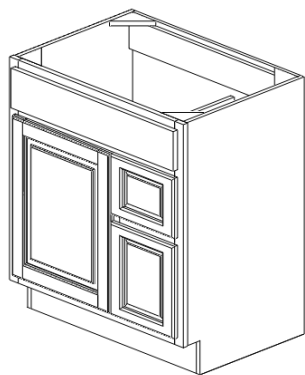

## TWO DRAWER VANITY UNIT

WILL COME WITH ONE  
DOOR FOR SMALLER UNITS

Sizes	Standard	Elite	Reserve
V2421D	✖	✖	✖
V3021D	✖	✖	✖
V3621D	✖	✖	✖
V4221D		✖	

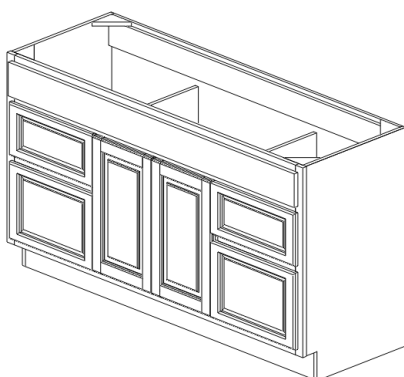
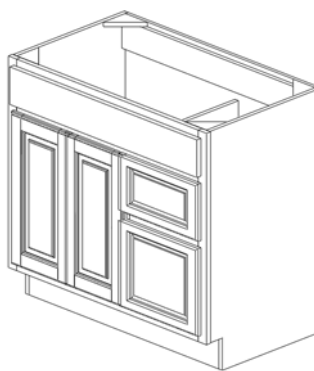

## FOUR DRAWER VANITY UNIT

DOORS / DRAWERS ARE  
CONFIGURED DIFFERENTLY  
BASED ON THE FINISH AND SIZE

Sizes	Standard	Elite	Reserve
V4221D	✖		✖
V4821D	✖	✖	✖
V6021D	✖	✖	✖
V7221D	✖	✖	✖

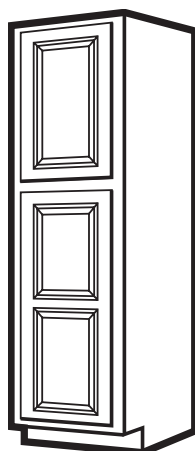
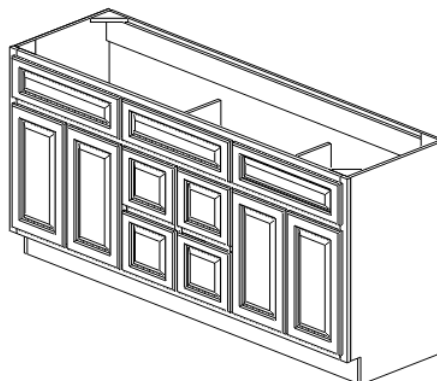

## LINEN CABINET

Sizes	Standard	Elite	Reserve
15"W x 78"H x 18"D	VLC7818		
	✖		
21"W x 84"H x 21"D		VLC2184	VLC2184
		✖	✖



MARQUIS CINNAMON



ITALIAN MAPLE



# CG CABINET INFORMATION

---

## ALL CABINETS FEATURE:

RAISED PANEL SOLID WOOD CABINET DOORS

3/4" SOLID WOOD FACE FRAMES

3/4" SOLID WOOD DRAWER FRONTS

CABINETS FRONTS AND SIDES ARE STAINED TO MATCH

1/2" CABINET GRADE PLYWOOD SIDE PANELS

5/8" CABINET GRADE PLYWOOD SHELVING

SELF ADJUSTING DRAWER SLIDES

ADJUSTABLE CONCEALED HINGES

[NATURAL OAK ONLY EXCEPTION - EXPOSED HINGES]

EASY ASSEMBLY SYSTEMS

SHIPPED UNASSEMBLED ON A PALLET IN INDIVIDUAL BOXES

6 COATS OF FINISH

---

## ELITE LINE CABINETS UPGRADES:

3/4" CABINET GRADE PLYWOOD SHELVING

FULL UNDERMOUNT GLIDES WITH SELF ADJUSTING DRAWER SLIDES

EASY ASSEMBLY UTILIZING A SIMPLE AND STURDY STEEL CLIP SYSTEM

8-10 COATS OF FINISH

---

## RESERVE LINE CABINETS UPGRADES:

SOFT CLOSE GLIDES, FULL EXTENSION DRAWERS, DOVE TAIL DRAWERS

FULL OVERLAY DOORS AND DRAWERS

10-13 COATS OF FINISH

---

## SPECIAL ORDER LINE

COMES FROM SEPARATE FACILITY SO SHIPS TO YOU IN 2-3 WEEKS

**CG**  
Available  
Finishes  
in  
Standard Line

**NATURAL  
OAK**

CATHEDRAL  
WALL DOOR



**GINGER  
MAPLE**

ROMAN ARCH  
WALL DOOR



**SUNSET  
MAPLE**

ROMAN ARCH  
WALL DOOR

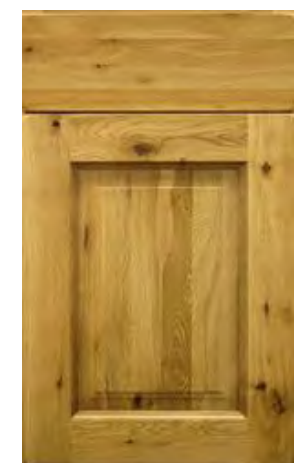

**RUSTIC  
TUSCANY**

SQUARE WALL  
DOOR GLAZE ON  
DOORS AND DRAWERS



**ITALIAN MAPLE**

SQUARE WALL DOOR  
GLAZE ON DOORS  
AND DRAWERS

Available  
Finishes  
In  
Elite Line  
**CG**

**CG**  
Available  
Finishes  
in  
Reserve Line

**BRINDLETON  
MAPLE**

SQUARE WALL  
DOOR GLAZE ON  
DOORS AND DRAWERS



**HAVENTON  
MAPLE**

SQUARE WALL  
DOOR GLAZE ON  
DOORS AND DRAWERS



**VINTAGE  
WHITE**

SQUARE WALL  
DOOR GLAZE ON  
DOORS AND DRAWERS



**MARQUIS  
CINNAMON**

ROPE TRIM  
ON DOORS  
AND DRAWERS

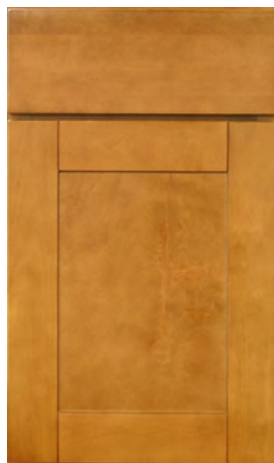

**AUTUMN  
SHAKER**

Available Finishes  
In  
Special Order

**CG**

# CG IMAGE GALLERY

---



GINGER MAPLE



SUNSET MAPLE



NATURAL OAK



# CG IMAGE GALLERY

.....



ITALIAN MAPLE



BRINDLETON MAPLE



FOR MORE INFORMATION  
ON  
INDIVIDUAL OR CONTAINER  
PURCHASES CONTACT:

CABINET GIANT  
7600 E GARDNER AVE  
KANSAS CITY, MO 64120

PHONE 1.877.484.4268 [TOLL FREE]  
816.379.4057 [LOCAL]

FAX 1.877.674.4268

EMAIL SALES@CABINETGIANT.COM  
INFO@CABINETGIANT.COM







*Forevermark*  
cabinetry™

[www.forevermarkcabinetry.com](http://www.forevermarkcabinetry.com)



As seen on



as TSG Cabinets



*Forevermark*  
cabinetry™

*Catalog*





# Forevermark

*At Forevermark Cabinetry,* our company beliefs are simple. We provide quality all-wood cabinetry. Cabinetry that is functional and stylish. Cabinetry that is reliable and durable enough for our families and whatever life throws at us. Cabinetry we have and use in our own homes every day.

Every aspect of Forevermark Cabinetry is built with these beliefs in mind. Forevermark Cabinetry features all wood construction, superior hardware, and durable paints and finishes. We carefully design each distinctive style to make sure your kitchen stands out. And with independently tested emissions approval on all Forevermark Cabinetry, you can rest assured that you are buying a product that is safe for your family.

You don't have to settle for an ordinary kitchen. With Forevermark Cabinetry, your kitchen can be

*everything you didn't know it could be.*

## Oasis (OA)

*What is an Oasis? An Oasis serves as refuge, relief, or pleasant change. With Oasis cabinets, you can transform your kitchen into a space to escape from the pressures of everyday life.*

*Oasis cabinets feature pillowed door and drawer design, with dovetail drawer boxes and full extension soft closing drawer glides. Create your own personal oasis in the comfort of your home and give yourself one less thing to worry about.*







## Wave Hill<sup>(WS)</sup>

*Wave Hill cabinetry brings a bit of Europe to your home without ever having to leave your kitchen. Constructed with dovetail drawer boxes and full extension soft closing drawers, Wave Hill is as functional and durable as it is beautiful. With its Italian inspired design, you'll feel like you're living in your own personal villa.*



## Santa Fe<sup>(ST)</sup>

*Lighten up your kitchen with the subtle glow of Santa Fe cabinets. Warm and inviting, Santa Fe's design features applied molding and notes of honey. Day or night, it's the perfect way to bring the soft radiance and beauty of a desert sunset into your kitchen.*





## New Yorker (HMSF)



Turn your kitchen into something remarkable with New Yorker cabinets. Its raised panel design, glaze detail, dovetail drawer boxes, and full extension soft closing drawers transforms your kitchen into a place of comfort with a hint of sophistication. Give your kitchen a splash of understated splendor with New Yorker.

## Pacifica (PC)

Deeply exquisite, Pacifica cabinets create an unparalleled richness to your kitchen. Pacifica is constructed with solid American Maple, dovetail drawer boxes, and full extension soft closing glides for the ultimate in kitchen elegance. Its deep color and design come together so you can surround yourself in a kitchen that feels as lush as it looks.







## Sienna Rope (MR)

*A uniquely refined cabinet style, Sienna Rope will take your kitchen to extraordinary heights. Sienna Rope is designed with a distinct finish, and engineered with full extension soft closing drawers and dovetail drawer boxes. Its delicate rope trim and glazing detail accentuates the craftsmanship of each cabinet. Make your kitchen your home's main attraction with Sienna Rope.*



## Shakertown (AK)

*Shakertown's simple and clean design complements any home. A design with a caramel honey finish that can look both traditional and modern, Shakertown can be used to achieve any look and endless possibilities. No matter what your vision, Shakertown cabinets create the perfect backdrop for all of your family's best memories.*







## Sandstone Rope<sup>(LR)</sup>

*Sandstone Rope incorporates the fine detail of rope trim and glazing with a sand finish that highlights the intricacies of the wood within. Sandstone Rope is fabricated with full extension soft closing drawers and dovetail drawer boxes, which couples with its design to give you a truly incomparable kitchen.*

## Country Oak Classic<sup>(CYOF)</sup>

*For a traditional style that works in any home, Country Oak Classic is the perfect match for those who appreciate the natural beauty of wood cabinetry. Oak cabinetry has long been treasured for its durability and versatility. Featuring a five piece header and raised panel doors, Country Oak Classic puts a spin on a time honored classic design.*







# Tribeca (TA)



Featuring bamboo doors and drawers

Whether you live in the city or the suburbs, Tribeca is the best choice for a kitchen with a metropolitan feel. Tribeca cabinets are constructed with bamboo, making it an attractive and eco-friendly option for your home. Featuring a sleek dark finish, dovetail drawer boxes, full extension soft closing drawer glides, and soft closing door hinges, Tribeca cabinets will set you apart from the rest. And, of course, being green is a trend that's always in style.

## Silver



Country Oak Classic



K-Honey\*



K-Cherry Glaze\*



K-Cinnamon Glaze\*

## Gold



Sante Fe



Shakertown



Ice White Shaker\*

## Diamond



Sandstone Rope



Sienna Rope



New Yorker



Wave Hill

## Platinum



Oasis

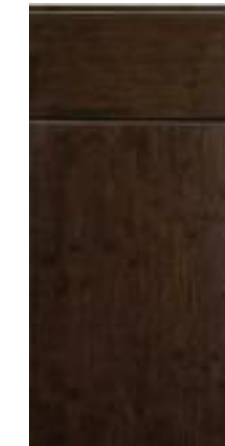

Tribeca



Pacifica

\*New 2011 Door Styles



# Accessories



# Sustainability carb2 compliant

Forevermark Cabinetry is fully committed to ensuring that our products are safe and environmentally friendly. All Forevermark Cabinetry products are independently tested to meet or surpass all California Air Resources Board standards for emissions. Every cabinet is labeled with our compliance to these testing criteria.

# Durability

Forevermark Cabinetry is proud to offer assembled cabinets that are Kitchen Cabinet Manufacturers Association certified. KCMA certified cabinets are recognized in the marketplace as a quality product able to perform after a rigorous battery of tests simulating years of household use.

# Warranty

Forevermark Cabinetry has a two to five year limited warranty on cabinetry parts and hardware, guaranteeing your cabinetry to be free from material or workmanship related defects under normal use to the original owner. For more information, ask a representative for complete details.

All rights reserved. Subject to change without notice. Photographs for reference only, color shown may differ slightly from actual color.

